

120 PIGGYBACK DETAIL

MAXIMUM TRUSS SPACING IS 24" O.C.
 DETAIL IS NOT APPLICABLE IF CAP SUPPORTS ADDITIONAL LOADS SUCH AS
 CUPOLA, STEEPLE, CHIMNEY OR DRAG STRUT LOADS.

UP TO 120 MPH WIND, 30.00 FT MEAN HGT, ASCE 7-02 OR ASCE 7-06, ENCLOSED BLDG, LOCATED ANYWHERE IN ROOF, CAT II, EXP C, WIND DL= 5.0 PSF KZ1=1.0.

NOTE: TOP CHORDS OF TRUSSES SUPPORTING PIGGYBACK CAP TRUSSES MUST BE ADEQUATELY BRACED BY SHEATHING OR PURLINS. THE BUILDING ENGINEER OF RECORD SHALL PROVIDE DIAGONAL BRACING OR OTHER SUITABLE ANCHORAGE TO PERMANENTLY RESTRAIN PURLINS.

** REFER TO ENGINEER'S SEALED TRUSS DESIGN DRAWING FOR PIGGYBACK AND BASE TRUSS SPECIFICATIONS.

DETAIL A

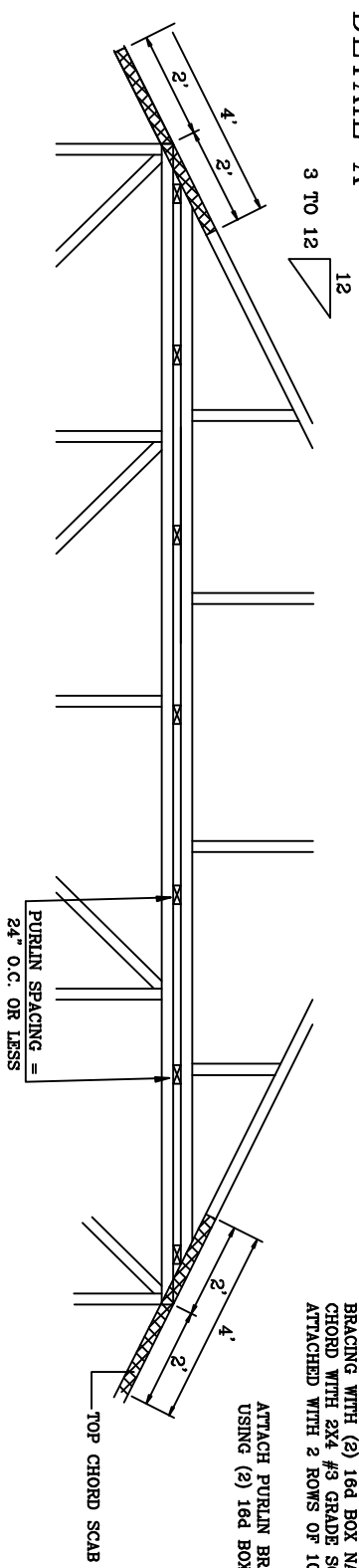

PIGGYBACK CAP TRUSS SLANT NAILED TO ALL TOP CHORD PURLIN BRACING WITH (2) 16d BOX NAILS (0.135"x3.5") AND SECURE TOP CHORD WITH 2x4 #3 GRADE SCAB (1 SIDE ONLY AT EACH END) ATTACHED WITH 2 ROWS OF 10d BOX NAILS (0.128"x3.0") AT 4" O.C.

ATTACH PURLIN BRACING TO THE FLAT TOP CHORD USING (2) 16d BOX NAILS (0.135"x3.5")

DETAIL B

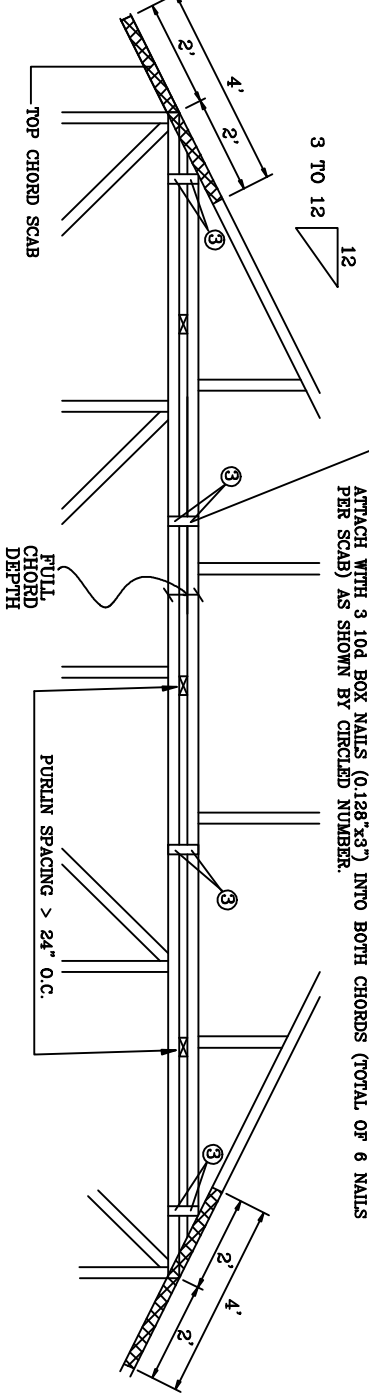

PIGGYBACK CAP TRUSS NAILED TO TOP CHORD OF BASE TRUSS AND SECURED WITH 2x4 SPF#2, FULL CHORD DEPTH SCABS @ 8" O.C. EACH FACE, STAGGERED 4" O.C. ATTACH WITH 3 10d BOX NAILS (0.128"x3") INTO BOTH CHORDS (TOTAL OF 6 NAILS PER SCAB) AS SHOWN BY CIRCLED NUMBER.

PIGGYBACK CAP TRUSS SLANT NAILED TO ALL TOP CHORD PURLIN BRACING WITH (2) 16d BOX NAILS (0.135"x3.5") AND SECURE TOP CHORD WITH 2x4 #3 GRADE SCAB (1 SIDE ONLY AT EACH END) ATTACHED WITH 2 ROWS OF 10d BOX NAILS (0.128"x3.0") AT 4" O.C.

ATTACH PURLIN BRACING TO THE FLAT TOP CHORD USING (2) 16d BOX NAILS (0.135"x3.5")

ALTERNATE ATTACHMENTS

- TRUJOLX
- USE 3x8 TRUJOLX PLATES FOR 2x4 CHORD MEMBER, AND 3x10 TRUJOLX PLATES FOR 2x6 AND LARGER CHORD MEMBERS. ATTACH TO EACH FACE @ 8" O.C. WITH (4) 0.120"x1.376" NAILS INTO CAP BOTTOM CHORD AND (4) 0.120"x1.376" NAILS INTO TRUJOLX PLATES MAY BE STAGGERED 4" O.C. FRONT TO BACK FACES.
- PLYWOOD GUSSET
- 8"x6"x1/2" RATED SHEATHING GUSSETS (EACH FACE), ATTACH @ 8" O.C. WITH (2) 6d COMMON (0.113"x2") NAILS PER GUSSET. (4) IN CAP BOTTOM CHORD AND (4) IN BASE TRUSS TOP CHORD. GUSSETS MAY BE STAGGERED 4" O.C. FRONT TO BACK FACES.



Earth Qty. MD 6004

WARNING READ AND FOLLOW ALL NOTES ON THIS SHEET

Trusses require extreme care in fabricating, handling, shipping, installing and bracing. Refer to and follow RCSS (Building Component Safety Information, by TPI and WTA) for safety practices prior to performing RCSS functions. Trusses shall provide temporary bracing per RCSS unless noted otherwise. Top chord shall have diagonal bracing for permanent restraint of webs. All bracing shall have bracing installed per RCSS sections B3 & B7. See this job's general notes page for more information.

IMPORTANT FURNISH COPY OF THIS DESIGN TO INSTALLATION CONTRACTOR.

ITW Building Components Group Inc. (ITWBCG) shall not be responsible for any deviation from this design, any failure to build the trusses in conformance with TPI or its contractor, handling, shipping, installing or any other use of the trusses. ITWBCG shall not be responsible for any damage to the building or its contents caused by the use of the trusses. ITWBCG shall not be responsible for any damage to the building or its contents caused by the use of the trusses. A seal on this drawing or cover page indicates acceptance and professional engineering responsibility solely for the truss component design shown. The suitability and use of this component for any building is the responsibility of the Building Designer per ANSI/TPI 1 Sec. 2.

REF	PIGGYBACK
DATE	1/1/09
DRWG	PB1200109
SPACING	24.0"